

Haslemere Lawn Tennis Club

PRIOR TO THE COMMENCEMENT OF ANY WORKS, THE BUILDER IS TO CHECK AND/OR DETERMINE ALL CONSTRUCTION DETAILS, INCLUDING CHECKING EXISTING SITE LEVELS AND DIMENSIONS. THE DRAWING IS TO BE READ IN CONJUNCTION WITH ALL OTHER PROJECT DRAWINGS, CONSTRUCTION NOTES AND/OR PROJECT SPECIFICATION. ALL DISCREPANCIES SHOULD BE REPORTED IMMEDIATELY.

Rev.	Date	Details	Drawn
A	09/21	More information added.	ES
B	10/21	Awning removed.	ES

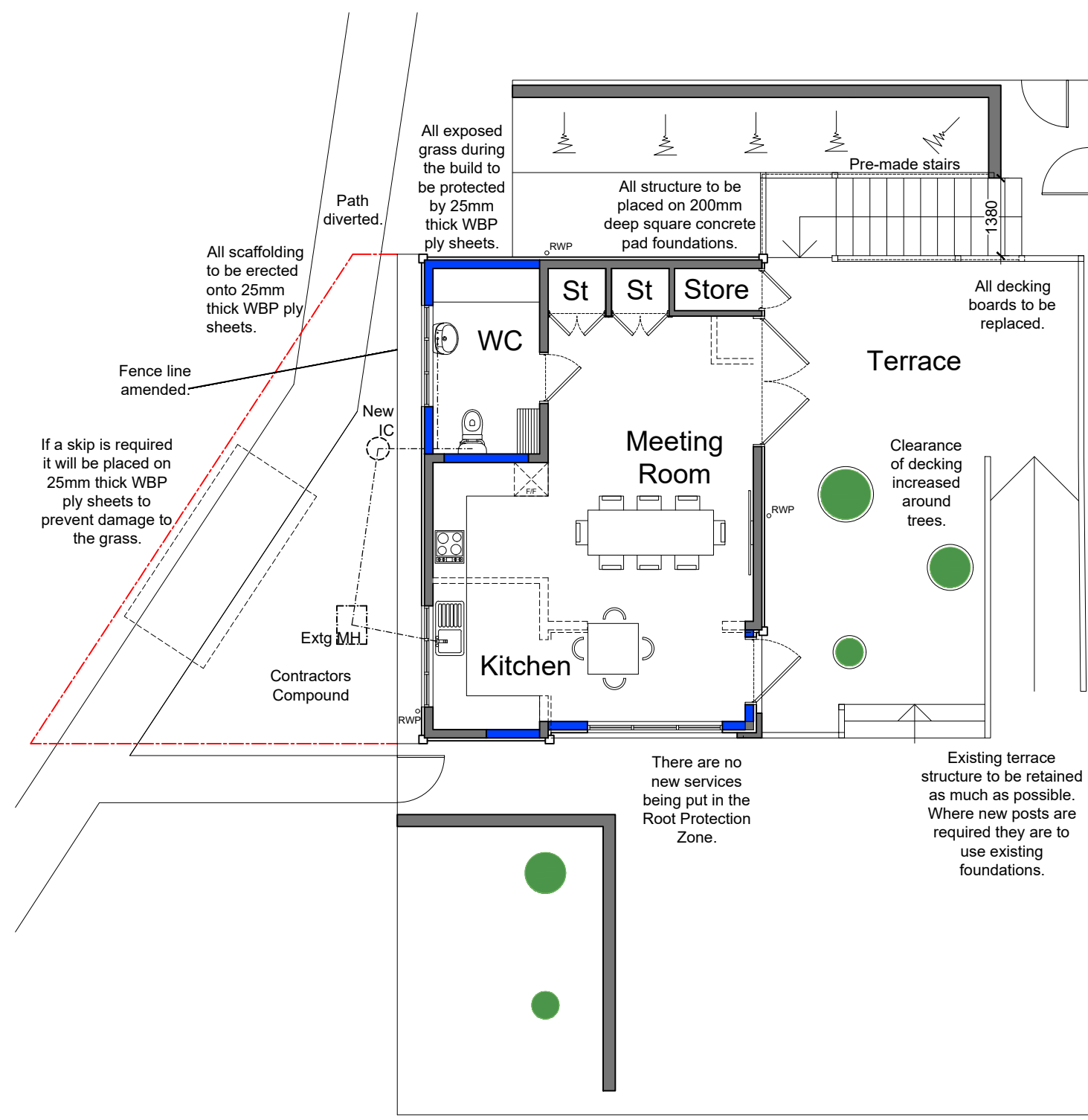

Site Plan (1:100)

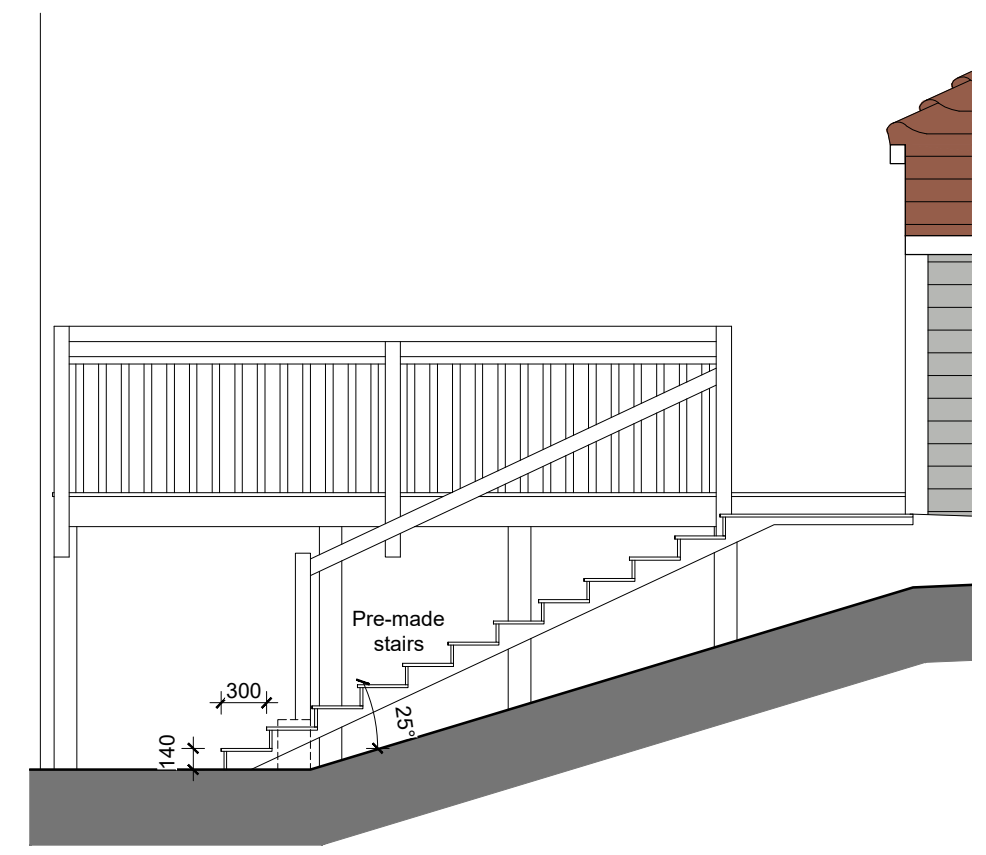
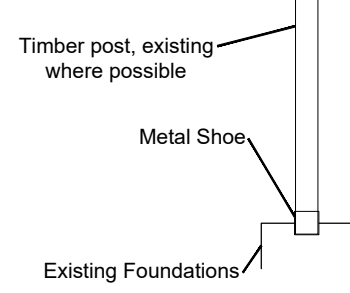

Stair Sections (1:50)

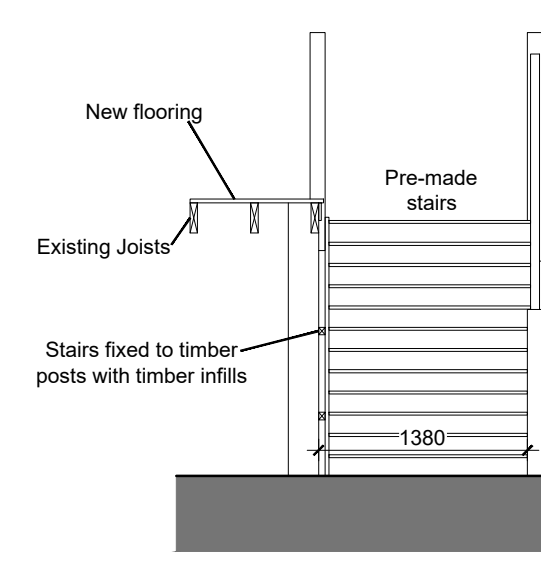

ALL GROUNDWORKS TO BE HAND-DUG TO PROTECT ROOT SYSTEMS

Client: **Haslemere Lawn Tennis Club**

Site Address: Old Haslemere Road, Haslemere, Surrey, GU27 2NN
 Description: Site Set-Up

Drawing Number: 20-031-BR-001 B

Status: **BUILDING REGULATIONS**

Scale: As Noted @ A3

Date: March 21

Drawn: ES

Checked: mb

THIS DRAWING IS THE COPYRIGHT OF BLUE SKY CAD LTD AND MUST NOT BE USED IN CONJUNCTION WITH ANY OTHER PROJECT WITHOUT WRITTEN CONSENT



BlueSky CAD
 Architectural Consultants
 FERNEBERGA HOUSE
 ALEXANDRA ROAD
 FARNBOROUGH
 HAMPSHIRE, GU14 6DQ
 t: 01252 757285
 w: www.blueskycad.co.uk